



---

**LIGNE D'AIR**



**AIRLINE**

---

**CATALOGUE 2012**



# INFINITY LINE

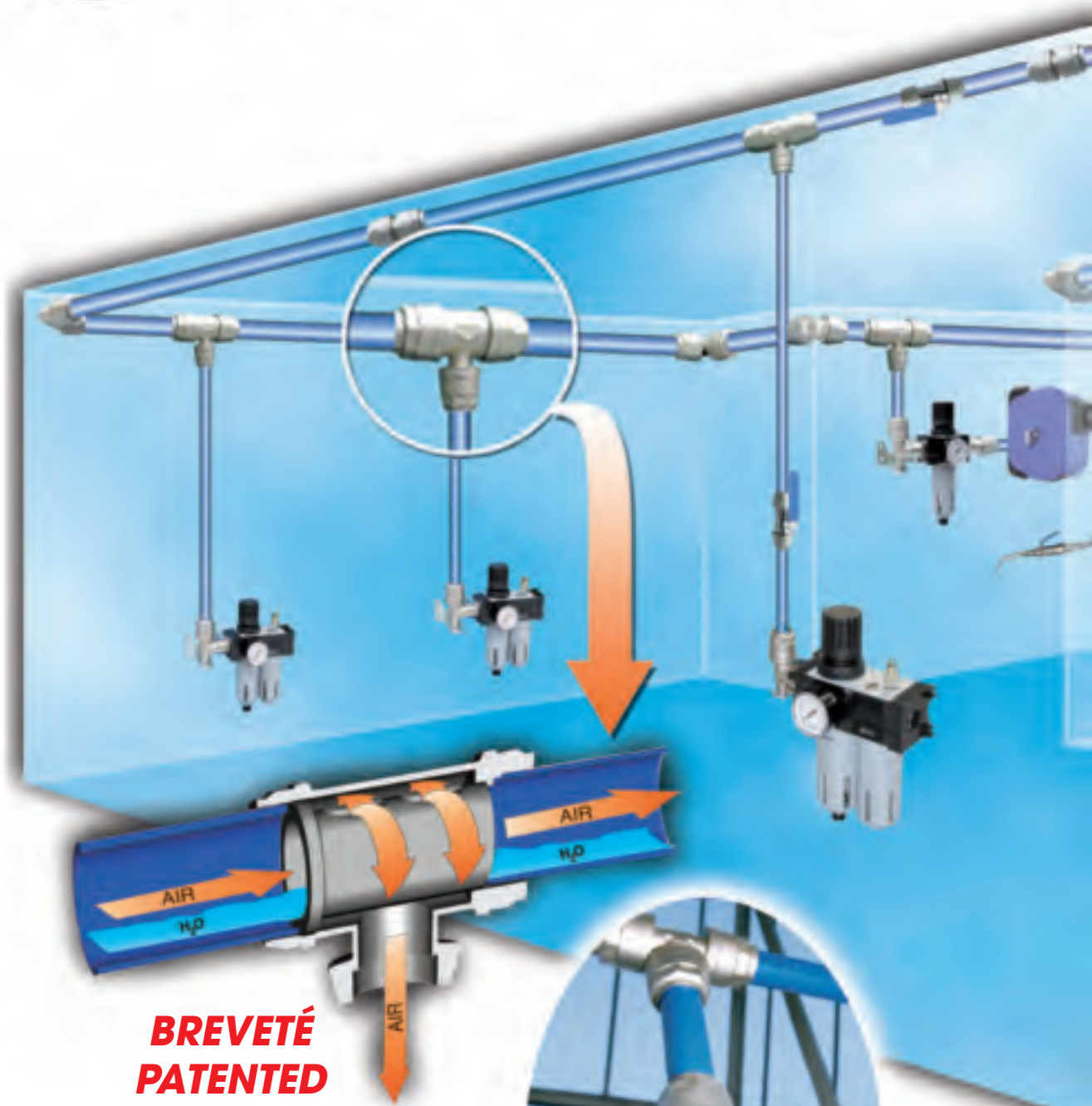

**BREVETÉ  
PATENTED**

**RACCORD POUR INSTALLATION  
DE LIGNE D'AIR COMPRIMÉ**

*PUSH-IN FITTINGS FOR INSTALLATION OF  
COMPRESSED-AIR PIPELINES*

**FACILITÉ ET RAPIDITÉ D'ASSEMBLAGE**

*EASILY AND QUICKLY ASSEMBLED*

# **DIVISION DU SYSTÈME CONTRE LA CONDENSATION**

*SEPARATION SYSTEM FOR CONDENSATION*

## **UN VASTE CHOIX D'ACCESSOIRES**

*WIDE RANGE OF ACCESSORIES*

## **FIABLE ET SÉCURITAIRE**

*RELIABILITY AND SECURITY ASSURED*



**VOLUME ÉLEVÉ**  
*HIGH FLOW RATE*



**FICHER EXCEL DISPONIBLE  
SUR DEMANDE**

*EXCEL FILE  
AVAILABLE ON REQUEST*

## Caractéristiques techniques / Technical characteristics

ø20 - ø25 - ø32 - ø40 - ø50 - ø63

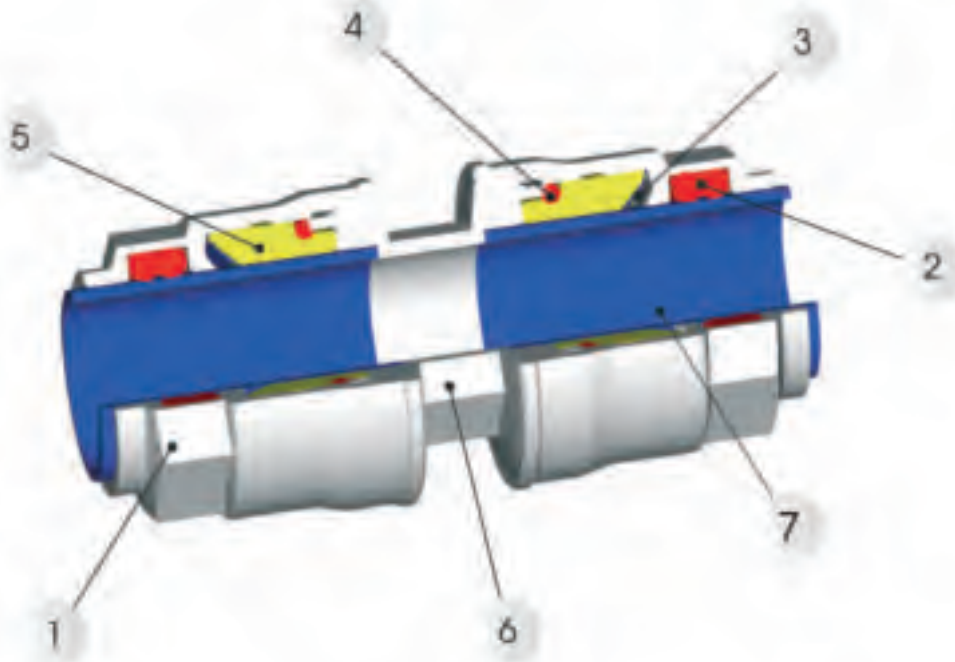

### Éléments et matériel / Component parts and materials

- 1 Boulon de cuivre plaqué nickel**
- 2 Scellant fait de NBR**
- 3 Anneau de retenue fait d'inox AISI 304**
- 4 Anneau d'étanchéité fait de NBR**
- 5 Anneau de sécurité fait de technopolymère**
- 6 Corps fait de laiton plaqué nickel**
- 7 Tube d'aluminium extrudé, calibré et peint**

- 1 Nut made in Nickel-Plated Brass
- 2 Seal made in NBR
- 3 Clamping Washer made in Inox AISI 304
- 4 O-RING Seals made in NBR
- 5 Safety Ring made in Technopolymeric
- 6 Body made in Nickel-Plated Brass
- 7 Extruded Aluminium tube calibrated and painting

### Pression / Pressures

**Pression minimum / Minimum pressure** -0.99 bar (0.099 Mpa)  
**Pression maximum / Maximum pressure** 15 bar (1.5 Mpa)

### Température / Temperatures

**Température minimum / Minimum temperature** -20°C  
**Température maximum / Maximum temperature** +80°C

### Fluide compatible / Compatible fluids

**Air comprimé / Compressed air.**  
**Vide d'air / Vacuum**  
**Gaz inerte (ARGON, AZOTE) / Inert Gas (NITROGEN, ARGON)**

### Résistance au feu / Fire resistance

**Le système ne peut propager le feu**  
 The system does not propagate any fires

### Filetage / Threads

**Filet mâle en conformité ISO 7**  
 Male threads taper in conformity with ISO  
**Filet femelle en conformité ISO 228**  
 Female threads in conformity with ISO 228

### Caractéristiques techniques du tube Technical characteristics to the tubes

|  |   |
|--|---|
| <b>Aluminium extrudé</b><br>0.2<br>Extruded Aluminium        | <b>UNI 9006/1 Al Mg 0.5 Si 0.4 Fe</b>                     |
| <b>Désignation UNI EN 573-3</b><br>Designations UNI EN 573-3 | <b>EN AW 6060 T6</b>                                      |
| <b>Surface traitée</b><br>Treated surface                    | <b>Peinture électrostatique</b><br>Electrostatic painting |
| <b>Poids spécifique</b><br>Specific weight                   | <b>2.70 Kg/dm<sup>3</sup></b>                             |
| <b>Coefficient d'expansion</b><br>Expansion coefficient      | <b>0.024 mm/(m °C)</b>                                    |

## Installation $\phi 20 - \phi 25 - \phi 32 - \phi 40$



1

**1 Raccords de  $\phi 20 - \phi 25 - \phi 32 - \phi 40$  sont pré-assemblés. Tubes de 4 m sont vernis, calibrés et bavurés.**

*Fittings of  $\phi 20 - \phi 25 - \phi 32 - \phi 40$  are pre-assembled. Tubes of 4 m are pre-coated, calibrated and burred.*

**2 Introduire le tube dans le raccord pour connexion automatique.**

*Push tube into the fitting for automatic connection.*



2

**3 Dans le cas d'un démontage, utilisez le couple de la charte pour réassembler le raccord.**

*In case of fitting disassembling, use the torques as in the chart to re-assemble the fitting.*

3

| Diamètre<br>Diameter | Couple<br>Torque |
|----------------------|------------------|
| 20                   | 300 cN.m         |
| 25                   | 300 cN.m         |
| 32                   | 400 cN.m         |
| 40                   | 650 cN.m         |

## Installation $\phi 50 - \phi 63$



1

**1 Raccords de  $\phi 50 - \phi 63$  sont pré-assemblés avec un collet desserré pour faciliter la connexion du tube. Tubes de 4 m vernis, calibrés et bavurés.**

*Fittings of  $\phi 50 - \phi 63$  are pre-assembled with nut untwisted to help tube connection. Tubes of 4 m are pre-coated, calibrated and burred.*

**2 Introduire le tube dans le raccord pour connexion automatique et utilisez le couple suggéré par la charte pour réassembler le raccord.**

*Push tube into the fitting for connection and tighten the nut using torques as in the chart.*



2

| Diamètre<br>Diameter | Couple<br>Torque |
|----------------------|------------------|
| 50                   | 75 N.m           |
| 63                   | 75 N.m           |

## Connexion du tube - Tube Connection

**La connexion adéquate du tube est confirmée par la position de la flèche pré-imprimée. Si vous devez couper le tube, marquez la distance du tube à insérer dans le raccord.**

*The correct connection of tube is confirmed by the position of the pre-stamped arrow. If you need to cut the tube, mark the distance of tube to insert in the fitting.*

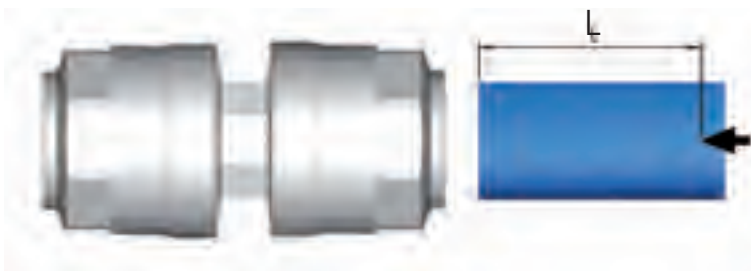

| Diamètre<br>Diameter | L<br>mm |
|----------------------|---------|
| 20                   | 31.5 mm |
| 25                   | 38.5 mm |
| 32                   | 46 mm   |
| 40                   | 52 mm   |
| 50                   | 63.5 mm |
| 63                   | 75.5 mm |

## Choisir le diamètre pour l'installation | Choose the diameter for the installation

**Le diagramme ci-dessous, vous permet de déterminer le diamètre de la ligne principale.**

*The Diagram below allows you to determine the diameter of the main line.*

- 1 Déterminez le débit du compresseur dans la colonne rouge.**  
*Choose the Flow rate of compressor in the Red column.*
- 2 Déterminez la distance entre le compresseur et le point le plus éloigné d'utilisation dans la colonne bleue.**  
*Choose the Distance between compressor and the most distant usage point in the Blue column.*
- 3 Suivez la ligne du débit et de la distance pour déterminer le diamètre nécessaire.**  
*Cross the lines of Flow rate and of the Distance to choose the diameter.*

| <b>Débit</b><br><i>Flow Rate</i> |              |            | <b>La distance entre le compresseur et le point le plus éloigné</b><br><i>Distance between compressor and the most distant using point.</i> |              |              |              |              |              |               |               |               |               |               |
|----------------------------------|--------------|------------|---|--------------|--------------|--------------|--------------|--------------|---------------|---------------|---------------|---------------|---------------|
| <b>NI/min</b>                    | <b>Nm3/h</b> | <b>cfm</b> | <b>25m</b>  | <b>50m</b>   | <b>100m</b>  | <b>150m</b>  | <b>200m</b>  | <b>300m</b>  | <b>400m</b>   | <b>500m</b>   | <b>1000m</b>  | <b>1500m</b>  | <b>2000m</b>  |
|                                  |              |            | <b>82ft</b>   | <b>164ft</b> | <b>328ft</b> | <b>492ft</b> | <b>656ft</b> | <b>984ft</b> | <b>1312ft</b> | <b>1640ft</b> | <b>3280ft</b> | <b>4921ft</b> | <b>6562ft</b> |
| 230                              | 14           | 8          | 20  | 20           | 20           | 20           | 20           | 20           | 20            | 20            | 20            | 25            | 25            |
| 650                              | 39           | 23         | 20  | 20           | 20           | 20           | 25           | 25           | 25            | 25            | 32            | 32            | 32            |
| 900                              | 54           | 32         | 20  | 20           | 20           | 25           | 25           | 25           | 32            | 32            | 32            | 40            | 40            |
| 1200                             | 72           | 42         | 20  | 20           | 25           | 25           | 25           | 32           | 32            | 32            | 40            | 40            | 40            |
| <b>1750</b>                      | <b>105</b>   | <b>62</b>  | 20  | 25           | 25           | 32           | 32           | <b>32</b>    | 32            | 40            | 40            | 50            | 50            |
| 2000                             | 120          | 71         | 20  | 25           | 32           | 32           | 32           | 32           | 40            | 40            | 40            | 50            | 50            |
| 2500                             | 150          | 88         | 25  | 25           | 32           | 32           | 32           | 40           | 40            | 40            | 50            | 50            | 50            |
| 3000                             | 180          | 106        | 25  | 32           | 32           | 32           | 40           | 40           | 40            | 40            | 50            | 50            | 63            |
| 3500                             | 210          | 124        | 25  | 32           | 32           | 40           | 40           | 40           | 40            | 50            | 50            | 63            | 63            |
| 4500                             | 270          | 159        | 32  | 32           | 40           | 40           | 40           | 50           | 50            | 50            | 63            | 63            | 63            |
| 6000                             | 360          | 212        | 32  | 40           | 40           | 40           | 50           | 50           | 50            | 63            | 63            | 63            | 63*           |
| 7000                             | 420          | 247        | 32  | 40           | 40           | 50           | 50           | 50           | 63            | 63            | 63            | 63*           | 110           |
| 8500                             | 510          | 300        | 40  | 40           | 50           | 50           | 50           | 63           | 63            | 63            | 63*           | 110           | 110           |
| 12000                            | 720          | 424        | 40  | 50           | 50           | 63           | 63           | 63           | 63            | 110           | 110           | 110           | 110           |
| 15000                            | 900          | 530        | 40  | 50           | 63           | 63           | 63           | 63           | 63*           | 110           | 110           | 110           | 110           |
| 18000                            | 1080         | 636        | 50  | 50           | 63           | 63           | 63           | 110          | 110           | 110           | 110           | 110           | 110           |
| 21000                            | 1260         | 742        | 50  | 63           | 63           | 63           | 63*          | 110          | 110           | 110           | 110           | 110           | 110*          |
| 26000                            | 1560         | 918        | 50  | 63           | 63           | 63*          | 110          | 110          | 110           | 110           | 110           | 110*          | 110*          |
| 31000                            | 1860         | 1095       | 63  | 63           | 63*          | 110          | 110          | 110          | 110           | 110           | 110           | 110*          | 110*          |
| 33000                            | 1980         | 1165       | 63  | 63           | 110          | 110          | 110          | 110          | 110           | 110           | 110*          | 110*          | 110*          |
| 44000                            | 2640         | 1554       | 63  | 63*          | 110          | 110          | 110          | 110          | 110           | 110           | 110*          | 110*          | 110*          |
| 50000                            | 3000         | 1766       | 63  | 110          | 110          | 110          | 110          | 110          | 110           | 110*          | 110*          | 110*          | 110*          |
| 58000                            | 3480         | 2048       | 63  | 110          | 110          | 110          | 110          | 110          | 110*          | 110*          | 110*          | 110*          | 110*          |
| 67000                            | 4020         | 2366       | 63*   | 110          | 110          | 110          | 110          | 110*         | 110*          | 110*          | 110*          | 110*          | 110*          |
| 75000                            | 4500         | 2648       | 110   | 110          | 110          | 110          | 110          | 110*         | 110*          | 110*          | 110*          | 110*          | 110*          |
| 83000                            | 4980         | 2931       | 110   | 110          | 110          | 110          | 110*         | 110*         | 110*          | 110*          | 110*          | 110*          | 110*          |
| 92000                            | 5520         | 3249       | 110   | 110          | 110          | 110*         | 110*         | 110*         | 110*          | 110*          | 110*          | 110*          | 110*          |
| 100000                           | 6000         | 3531       | 110   | 110          | 110          | 110*         | 110*         | 110*         | 110*          | 110*          | 110*          | 110*          | 110*          |

Pression 7 bar - Perte de pression totale 4% / Pressure 7 bar - Total pressure drop 4%

\* Perte de pression totale de plus de 4% / \* Pressure drop is higher than 4%

### Exemple | Example

**Débit : 62 cfm**

**La distance entre le compresseur et le point le plus éloigné : 300 m**

**Diamètre nécessaire : 32**

**Flow rate: 62 cfm**

**Distance between compressor and most distant using point: 300 m**

**Tube diameter: 32**

*Indicateur du débit du compresseur à 100 PSI | Indicative flow rates of the compressors at 100 PSI*



| KW   | CV  | NI/min |
|------|-----|--------|
| 1.5  | 2   | 230    |
| 3    | 4   | 460    |
| 4    | 6   | 650    |
| 5.5  | 7.5 | 900    |
| 7.5  | 10  | 1200   |
| 11   | 15  | 1750   |
| 12.5 | 17  | 2000   |
| 15   | 20  | 2500   |
| 18   | 25  | 3000   |
| 22   | 30  | 3500   |
| 29   | 40  | 4500   |
| 37   | 50  | 6000   |
| 45   | 60  | 7000   |
| 55   | 75  | 8500   |
| 74   | 100 | 12000  |
| 92   | 125 | 15000  |
| 110  | 150 | 18000  |
| 132  | 180 | 21000  |
| 170  | 230 | 26000  |
| 200  | 270 | 31000  |
| 250  | 300 | 44000  |

**EXEMPLE D'UNE PARFAITE LIGNE D'AIR  
EXAMPLE OF A PERFECT AILINE**

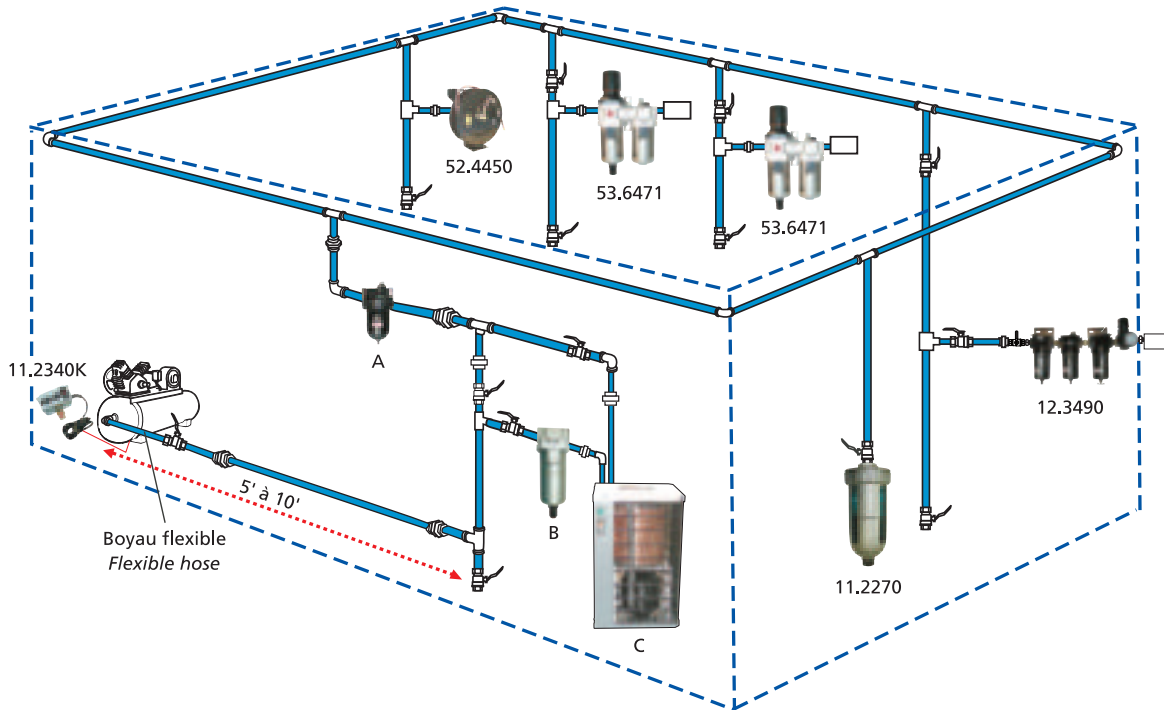

## Diamètre des tubes pour les sorties | Tube diameter for the outlets

Diamètres des tubes pour les sorties disponibles: Specifications about available tube diameters for the outlets:

Ø20 avec un débit jusqu'à 1750 NI/min  
Ø25 avec un débit jusqu'à 3500 NI/min  
Ø32 avec un débit jusqu'à 6.000 NI/min

Ø 20 with flow rate up to 1750 NI/min  
Ø 25 with flow rate up to 3500 NI/min  
Ø 32 with flow rate up to 6000 NI/min

## Expansion et rétrécissement dû à la chaleur | Expansion and shrinkage due to the heat

Pour calculer l'expansion / rétrécissement linéaire, vous pouvez utiliser la formule suivante :

$$\Delta L = \Delta T \times L \times \alpha$$

- Ø **L** = L'expansion / rétrécissement en mm
- Ø **T** = La variation entre la température d'opération et celle de l'installation en °C
- L** = Longueur de tube en m
- α** = Facteur d'expansion linéaire pour l'aluminium est 0.024 mm/m °C

- L'installation doit être positionnée de façon à permettre l'expansion et le rétrécissement aux deux extrémités et les supports doivent être fixés comme sur la photo.

To calculate the linear expansion - shrinkage we can use the following formula:

$$\Delta L = \Delta T \times L \times \alpha \text{ i.e.:}$$

- Ø **L** = Linear expansion - shrinkage in mm
- Ø **T** = Heat variation between the operating temperature and the installation one at °C
- L** = Tube length in m
- α** = Linear expansion factor, for the aluminium it is 0.024 mm/ m °C

- The installation has to be positioned, considering at the two ends free space which permits the expansion - shrinkage and supports have to be fixed as shown in the picture:

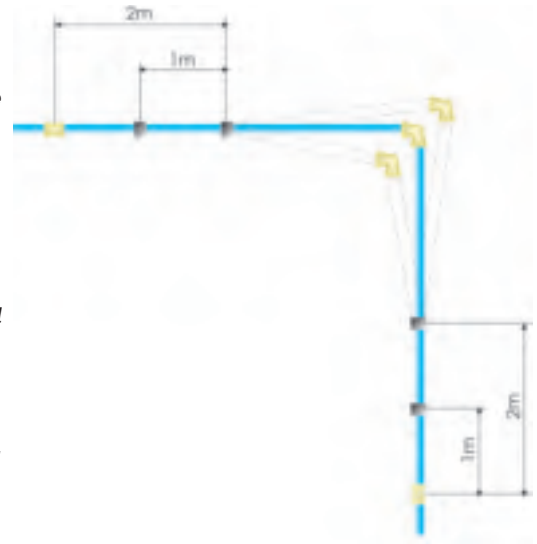

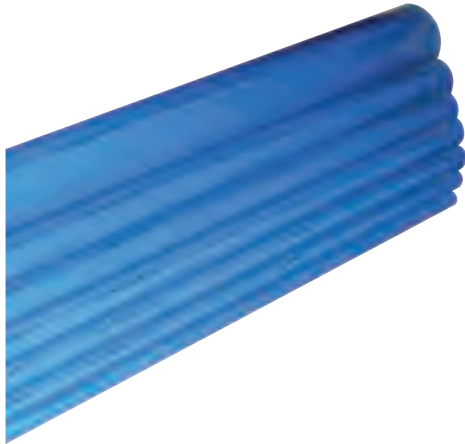

## 90000

**TUBE D'ALUMINIUM CALIBRÉ DE COULEUR BLEUE**  
CALIBRATED ALUMINIUM TUBES BLUE COLOUR

| Ø Extérieur<br>Outside Ø | Épaisseur<br>Thickness | Pression<br>Pressure | Poids<br>Weight | Longueur<br>Length |
|--------------------------|------------------------|----------------------|-----------------|--------------------|
| mm                       | mm                     | bar                  | gr/m            |                    |
| <b>20*</b>               | 1.5                    | 15                   | 235             | 4 m                |
| <b>25*</b>               | 1.5                    | 15                   | 298             | 4 m                |
| <b>32*</b>               | 1.5                    | 15                   | 387             | 4 m                |
| <b>40*</b>               | 1.5                    | 15                   | 490             | 4 m                |
| <b>50*</b>               | 2                      | 15                   | 814             | 4 m                |
| <b>63</b>                | 2                      | 15                   | 1034            | 4 m                |

\*Longueur de 6 mètre disponible / 6 meter length available

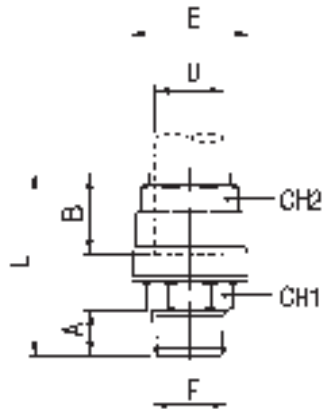

## 90011 (NPT)

**RACCORD DROIT MÂLE - STRAIGHT MALE ADAPTOR**

| D                  | F    | A    | B    | E    | L  | CH1 | CH2 |
|--------------------|------|------|------|------|----|-----|-----|
| <b>20 - 1/2</b>    | 14   | 31.5 | 34.5 | 56   | 22 | 30  |     |
| <b>25 - 3/4</b>    | 16.5 | 38.5 | 42.5 | 66   | 27 | 35  |     |
| <b>32 - 1"</b>     | 19   | 46   | 52   | 76.5 | 34 | 45  |     |
| <b>50 - 1 1/2"</b> | 21.5 | 63.5 | 73   | 105  | 50 | 65  |     |
| <b>63 - 2"</b>     | 24   | 75.5 | 92   | 124  | 65 | 70  |     |

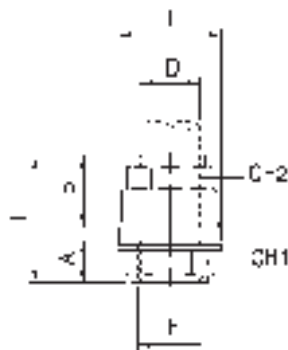

## 90030 (BSP)

**RACCORD DROIT FEMELLE - STRAIGHT FEMALE ADAPTOR**

| D                  | F    | A    | B    | E    | L  | CH1 | CH2 |
|--------------------|------|------|------|------|----|-----|-----|
| <b>20 - 1/2</b>    | 15   | 31.5 | 34.5 | 49   | 24 | 30  |     |
| <b>25 - 3/4</b>    | 16.5 | 38.5 | 42.5 | 56.5 | 32 | 35  |     |
| <b>32 - 1"</b>     | 19   | 46   | 52   | 66.5 | 38 | 45  |     |
| <b>40 - 1 1/4"</b> | 22   | 52   | 63   | 76   | 50 | 55  |     |
| <b>50 - 1 1/2"</b> | 22   | 63.5 | 73   | 85.5 | 55 | 65  |     |
| <b>63 - 2"</b>     | 22   | 75.5 | 92   | 99.5 | 65 | 70  |     |

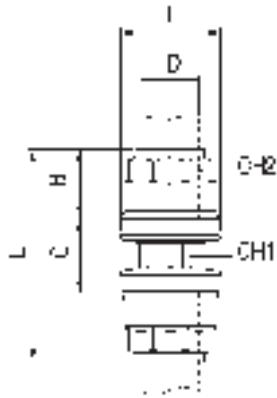

## 90040

**CONNECTEUR DROIT** - STRAIGHT CONNECTOR

| D         | B    | C    | E    | L     | CH1 | CH2 |
|-----------|------|------|------|-------|-----|-----|
| <b>20</b> | 31.5 | 14.5 | 34.5 | 76.5  | 21  | 30  |
| <b>25</b> | 38.5 | 13.5 | 42.5 | 90.5  | 26  | 35  |
| <b>32</b> | 46   | 14.5 | 52   | 106.5 | 32  | 45  |
| <b>40</b> | 52   | 21   | 63   | 125   | 41  | 55  |
| <b>50</b> | 63.5 | 21.5 | 73   | 148.5 | 50  | 65  |
| <b>63</b> | 75.5 | 25   | 92   | 176.5 | 65  | 70  |



## 90130

**CONNECTEUR COUDE** - ELBOW CONNECTOR

| D         | B    | C    | E    | L     | CH1 | CH2 |
|-----------|------|------|------|-------|-----|-----|
| <b>20</b> | 31.5 | 19   | 34.5 | 51    | 21  | 30  |
| <b>25</b> | 38.5 | 23   | 42.5 | 61.5  | 26  | 35  |
| <b>32</b> | 46   | 28   | 52   | 74.5  | 34  | 45  |
| <b>40</b> | 52   | 34   | 63   | 86.5  | 41  | 55  |
| <b>50</b> | 63.5 | 40.5 | 73   | 104   | 50  | 65  |
| <b>63</b> | 75.5 | 52   | 92   | 127.5 | 65  | 70  |



## 90132

**RÉDUIT EN COUDE** - ELBOW REDUCTOR

| D1        | D2        |
|-----------|-----------|
| <b>25</b> | <b>20</b> |
| <b>32</b> | <b>20</b> |
| <b>32</b> | <b>25</b> |
| <b>40</b> | <b>20</b> |
| <b>40</b> | <b>25</b> |
| <b>40</b> | <b>32</b> |

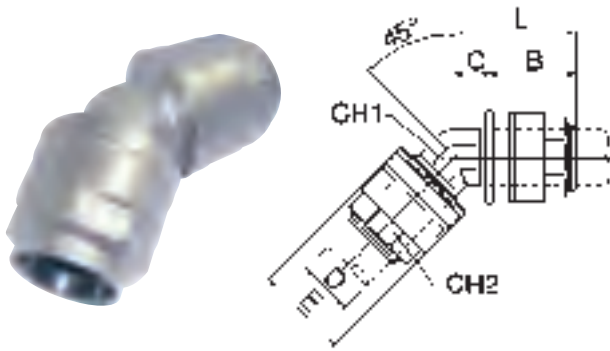

## 90140

CONNECTEUR 135° - 135° CONNECTOR

| D         | B    | C    | E    | L    | CH1 | CH2 |
|-----------|------|------|------|------|-----|-----|
| <b>20</b> | 31.5 | 12.5 | 34.5 | 44   | 21  | 30  |
| <b>25</b> | 38.5 | 13.5 | 42.5 | 52   | 26  | 35  |
| <b>32</b> | 46   | 15   | 52   | 61   | 34  | 45  |
| <b>40</b> | 52   | 18   | 63   | 70   | 41  | 55  |
| <b>50</b> | 63.5 | 20   | 73   | 83.5 | 50  | 65  |
| <b>63</b> | 75.5 | 24   | 92   | 99.5 | 65  | 70  |

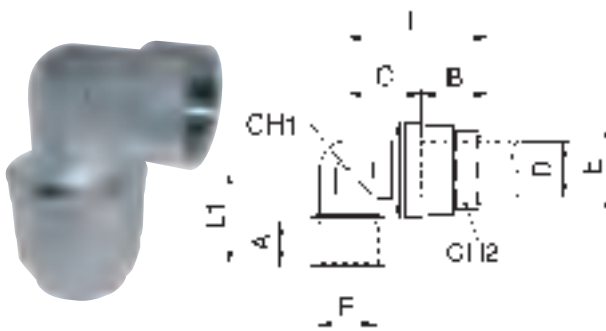

## 90160

RACCORD COUDE FEMELLE / TUBE  
ELBOW ADAPTOR FEMALE-TUBE

| D                  | F    | A    | B    | C    | E     | L    | L1 | CH | CH1 |
|--------------------|------|------|------|------|-------|------|----|----|-----|
| <b>20 - 1/2</b>    | 13   | 31.5 | 19   | 34.5 | 51    | 34.5 | 21 | 30 |     |
| <b>25 - 3/4</b>    | 14.5 | 38.5 | 23   | 42.5 | 61.5  | 38.5 | 26 | 35 |     |
| <b>32 - 1"</b>     | 16.5 | 46   | 28   | 52   | 74.5  | 47.5 | 34 | 45 |     |
| <b>40 - 1 1/4"</b> | 20   | 52   | 34   | 63   | 86.5  | 56.5 | 41 | 55 |     |
| <b>50 - 1 1/2"</b> | 22   | 63.5 | 40.5 | 73   | 104   | 64.7 | 50 | 65 |     |
| <b>63 - 2"</b>     | 21.7 | 75.5 | 52   | 92   | 127.5 | 77   | 65 | 70 |     |

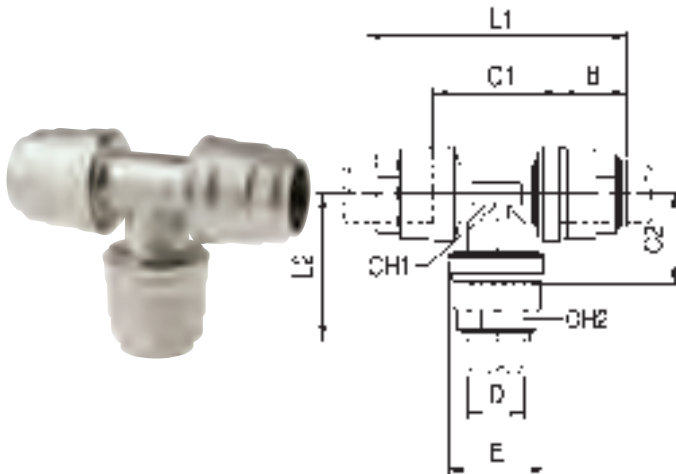

## 90230

CONNECTEUR T - TEE CONNECTOR

| D         | E    | B    | C1   | C2   | L1    | L2   | CH1 | CH2 |
|-----------|------|------|------|------|-------|------|-----|-----|
| <b>20</b> | 34.5 | 31.5 | 34.5 | 22.5 | 98    | 54.5 | 21  | 30  |
| <b>25</b> | 42.5 | 38.5 | 37.5 | 26   | 113.5 | 65   | 26  | 35  |
| <b>32</b> | 52   | 46   | 46.5 | 31.5 | 138.5 | 77   | 34  | 45  |
| <b>40</b> | 63   | 52   | 55.5 | 38   | 159.5 | 90   | 41  | 55  |
| <b>50</b> | 73   | 63.5 | 69   | 44.5 | 196   | 108  | 50  | 65  |
| <b>63</b> | 92   | 75.5 | 87   | 55.5 | 238.5 | 131  | 65  | 70  |



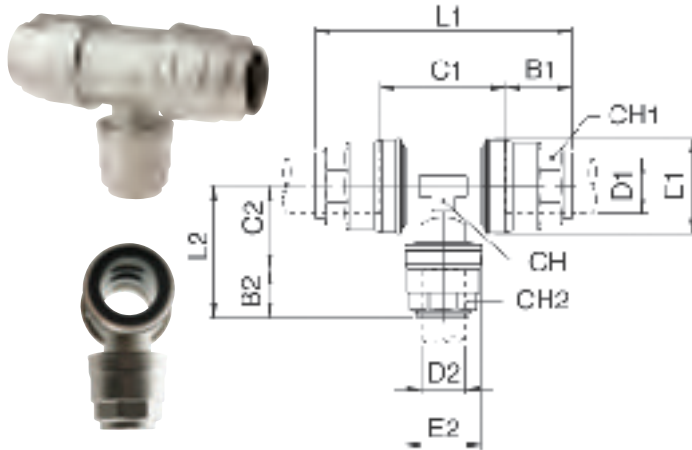

## 90235

CONNECTEUR POUR SORTIE - FITTING CONNECTOR FOR OUTLET

| D1             | D2   | B1   | B2   | C1   | C2   | E1   | E2    | L1   | L2 | CH | CH1 | CH2 |
|----------------|------|------|------|------|------|------|-------|------|----|----|-----|-----|
| <b>20 - 20</b> | 31.5 | 31.5 | 48   | 22.5 | 34.5 | 34.5 | 109   | 54   | 28 | 30 | 30  |     |
| <b>25 - 20</b> | 38   | 31.5 | 45.5 | 27.5 | 42.5 | 34.5 | 121.5 | 59   | 35 | 35 | 30  |     |
| <b>32 - 20</b> | 46   | 31.5 | 54.5 | 31.5 | 52   | 34.5 | 146.5 | 63   | 45 | 45 | 30  |     |
| <b>32 - 25</b> | 46   | 38   | 54.5 | 31.5 | 52   | 42.5 | 146.5 | 70   | 45 | 45 | 35  |     |
| <b>40 - 20</b> | 52.5 | 31.5 | 60   | 34.5 | 63   | 34.5 | 165.5 | 66   | 55 | 55 | 30  |     |
| <b>40 - 25</b> | 52.5 | 38   | 60   | 34.5 | 63   | 42.5 | 165.5 | 87   | 55 | 55 | 35  |     |
| <b>50 - 20</b> | 63.5 | 31.5 | 73.5 | 41.5 | 73   | 34.5 | 201   | 73   | 65 | 65 | 30  |     |
| <b>50 - 25</b> | 63.5 | 38.5 | 73.5 | 41   | 73   | 42.5 | 201   | 80   | 65 | 65 | 35  |     |
| <b>50 - 32</b> | 63.5 | 46   | 73.5 | 41   | 73   | 52   | 201   | 87.5 | 65 | 65 | 45  |     |
| <b>63 - 20</b> | 77   | 31.5 | 86   | 49.5 | 92   | 34.5 | 237.5 | 81   | 80 | 70 | 30  |     |
| <b>63 - 25</b> | 77   | 38.5 | 86   | 49   | 92   | 42.5 | 237.5 | 88   | 80 | 70 | 35  |     |
| <b>63 - 32</b> | 77   | 46   | 86   | 49   | 92   | 52   | 237.5 | 95.5 | 80 | 70 | 45  |     |

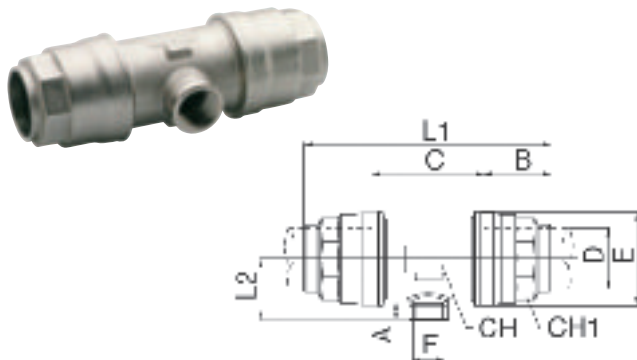

## 90236 (NPT)

RACCORD FEMELLE POUR SORTIE - FEMALE FITTING ADAPTOR FOR OUTLET

| D            | F          | A    | B    | C    | E    | L1    | L2   | CH | CH1 |
|--------------|------------|------|------|------|------|-------|------|----|-----|
| <b>20-06</b> | <b>3/8</b> | 13.5 | 31.5 | 48   | 34.5 | 109   | 28   | 28 | 30  |
| <b>20-08</b> | <b>1/2</b> | 13.5 | 31.5 | 48   | 34.5 | 109   | 28   | 28 | 30  |
| <b>25-06</b> | <b>3/8</b> | 13.5 | 38.5 | 45.5 | 42.5 | 121.5 | 31   | 35 | 35  |
| <b>25-08</b> | <b>1/2</b> | 13.5 | 38.5 | 45.5 | 42.5 | 121.5 | 31   | 35 | 35  |
| <b>32-08</b> | <b>1/2</b> | 13.5 | 46   | 54.5 | 52   | 146.5 | 36.5 | 45 | 45  |
| <b>40-08</b> | <b>1/2</b> | 13.5 | 52.5 | 60   | 63   | 165.5 | 41.5 | 55 | 55  |
| <b>50-12</b> | <b>3/4</b> | 14.5 | 63.5 | 73.5 | 73   | 201   | 47.5 | 65 | 65  |
| <b>63-12</b> | <b>3/4</b> | 14.5 | 77   | 86   | 92   | 237.5 | 55   | 80 | 70  |

*Fonction 90235 - 90236 | Function 90235 - 90236*

Ce raccord est une alternative au traditionnel cou de cygne; il représente une solution plus rapide et plus économique. L'efficacité du système interne permet à l'air de rejoindre le point d'utilisation sans condensation qui demeure dans le circuit principal et peut être drainé à l'endroit qui convient le mieux.

*This fitting is a valid alternative to the traditional swan-neck; it shows itself as a quicker and more economical solution. The efficient internal system allows the air to reach the outlet without any condensation which stays within the main circuit and then it can be drained at the most convenient point.*

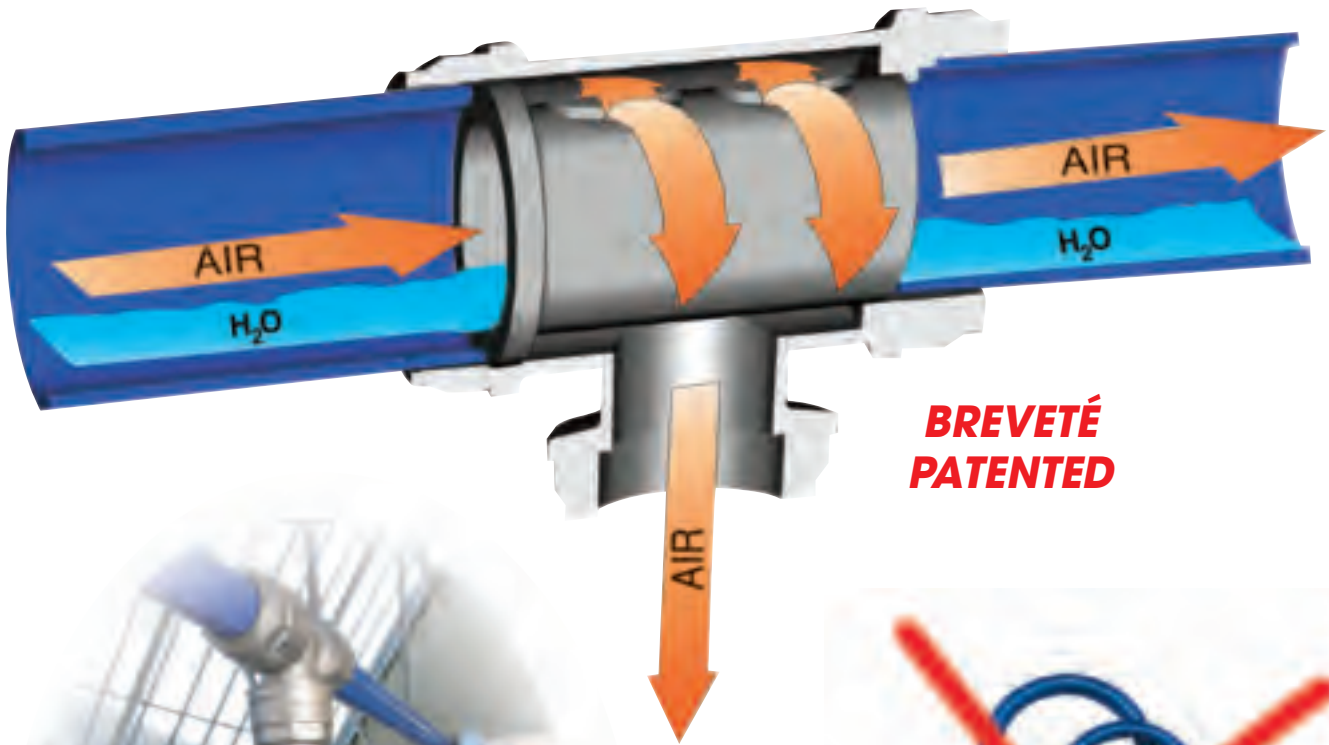

# 90240

CONNECTEUR D'ATTACHE DE SELLE - SADDLE CLAMP CONNECTOR

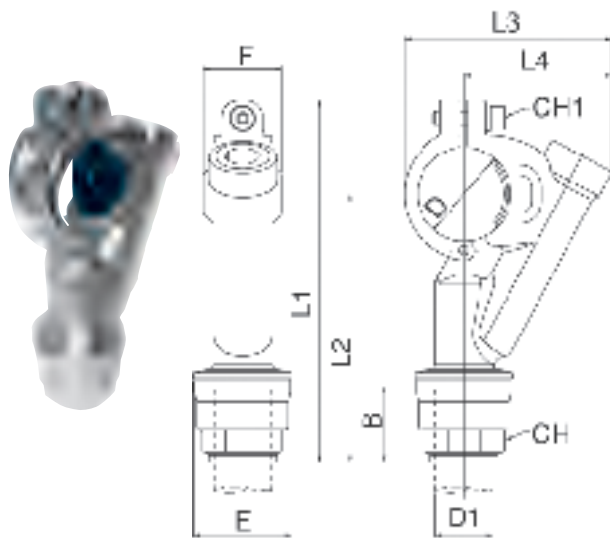

| D  | D1 | B    | E    | F    | L1    | L2    | L3    | L4 | CH | CH1 |
|----|----|------|------|------|-------|-------|-------|----|----|-----|
| 32 | 20 | 31.5 | 34.5 | 34   | 136.5 | 100.5 | 78    | 57 | 30 | 5   |
| 32 | 25 | 38.5 | 42.5 | 34   | 144.5 | 108.5 | 78    | 57 | 35 | 5   |
| 40 | 20 | 31.5 | 34.5 | 34   | 148.5 | 108   | 89.5  | 64 | 30 | 5   |
| 40 | 25 | 38.5 | 42.5 | 34   | 156.5 | 116   | 89.5  | 64 | 35 | 5   |
| 50 | 20 | 31.5 | 34.5 | 42.5 | 167.5 | 118.5 | 105.5 | 74 | 30 | 6   |
| 50 | 25 | 38.5 | 42.5 | 42.5 | 175.5 | 126.5 | 105.5 | 74 | 35 | 6   |
| 63 | 20 | 31.5 | 34.5 | 42.5 | 185   | 130   | 119   | 81 | 30 | 6   |
| 63 | 25 | 38.5 | 42.5 | 42.5 | 193   | 138   | 119   | 81 | 35 | 6   |

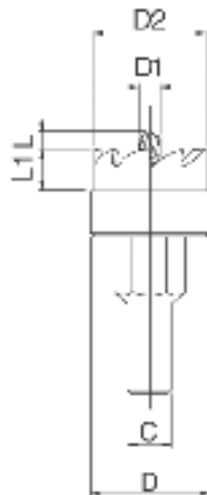
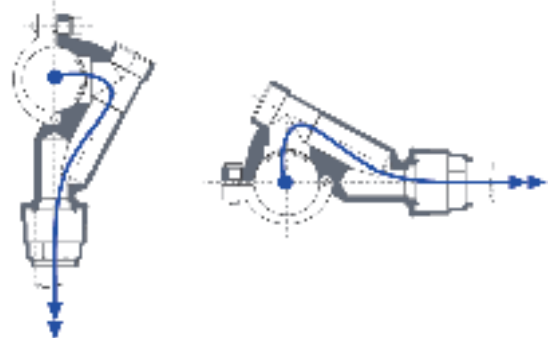

# 90241

OUTIL POUR LE CONNECTEUR D'ATTACHE DE SELLE  
TOOL FOR SADDLE CLAMP CONNECTOR

| TUBE  | C | D  | D1 | D2   | L | L1 |
|-------|---|----|----|------|---|----|
| 32 40 | 9 | 24 | 6  | 23.5 | 3 | 10 |
| 50 63 | 9 | 31 | 6  | 30.5 | 3 | 9  |

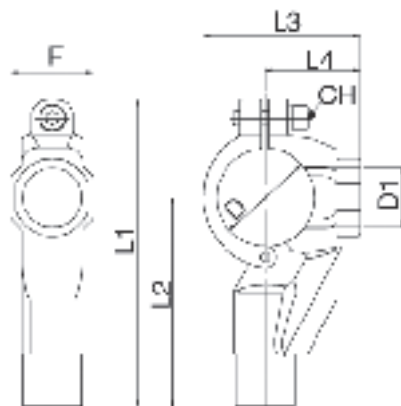

# 90242

GABARIT DE FORAGE - DRILLING JIG

| D  | D1   | F    | L1    | L2    | L3 | L4   | CH |
|----|------|------|-------|-------|----|------|----|
| 32 | 24.5 | 34   | 115   | 79    | 56 | 35   | 5  |
| 40 | 24.5 | 34   | 127   | 86.5  | 65 | 39.5 | 5  |
| 50 | 31.5 | 42.5 | 146   | 97    | 79 | 47.5 | 6  |
| 63 | 31.5 | 42.5 | 163.5 | 108.5 | 93 | 55   | 6  |

## Installation 90240

**Le connecteur d'attache de selle permet l'installation d'un nouveau point d'utilisation sans avoir à retirer la tubulure en place.**

*Saddle clamp allows to set up a new drop on an existing system without removing tubes.*

- 
- 1 Dépressuriser**  
*Depressurization*
  - 2 Montez l'article 90242 sur le tube à l'endroit désigné. Assurez-vous que le gabarit soit dirigé dans l'axe du nouveau conduit. Il est possible de fixer un tube de diamètre 20 sur le gabarit, pour positionner le forage.**  
*Mount art. 90242 on tube wherever necessary. Be careful that the jig bore intersect the axis of tube drop. It is possible to connect a 20mm tube to ease the positioning of the drilling jig.*
  - 3 Forez le tube avec l'outil approprié.**  
*Drill the tube with proper tool art. 90241*
  - 4 N'endommagez pas le tube.**  
*Do not damage the inside of the tube.*
  - 5 Retirez l'article 90242 et le matériel résiduel.**  
*Take down art. 90242 and remove residual material*
  - 6 Installez et boulonnez l'article 90240. Assurez-vous que la lèvre d'étanchéité soit positionnée correctement dans l'orifice. Boulonnez.**  
*Mount and screw up art. 90240. Be careful that lipseal lays into the hole correctly. Screw up*

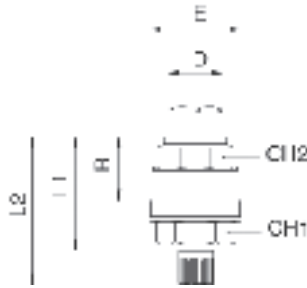

## 90260

**RACCORD AVEC ÉCHAPPEMENT CONDENSÉ INCORPORÉ**  
*FITTING WITH CONDENSE EXHAUST INCORPORATED*

| D         | B    | E    | L1    | L2   | CH1 | CH2 |
|-----------|------|------|-------|------|-----|-----|
| <b>20</b> | 36   | 34.5 | 52.5  | 67   | 32  | 30  |
| <b>25</b> | 38.5 | 42.5 | 57.5  | 72   | 32  | 35  |
| <b>32</b> | 46   | 52   | 67.5  | 82   | 38  | 45  |
| <b>40</b> | 52   | 63   | 77    | 91.5 | 50  | 55  |
| <b>50</b> | 63.5 | 73   | 86.5  | 101  | 55  | 65  |
| <b>63</b> | 75.5 | 92   | 100.5 | 115  | 65  | 70  |

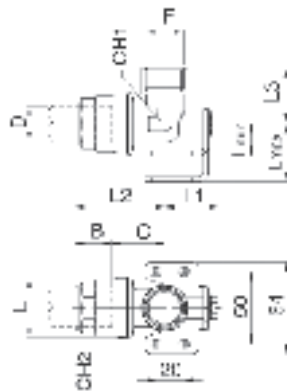

## 90601 (NPT)

**RACCORD AVEC SUPPORT - BRACKET FITTING**

| D - F           | B    | C    | E    | L1 | L2   | L3   | Lmax | Lmin | CH1 | CH2 |
|-----------------|------|------|------|----|------|------|------|------|-----|-----|
| <b>20 - 1/2</b> | 31.5 | 19.5 | 34.5 | 35 | 51   | 35   | 40   | 22   | 21  | 30  |
| <b>25 - 1/2</b> | 38   | 23   | 42.5 | 37 | 62   | 39   | 40   | 22   | 26  | 35  |
| <b>32 - 1/2</b> | 46   | 28   | 52   | 41 | 74.5 | 48.5 | 40   | 22   | 34  | 45  |

**AJUSTABLE / ADJUSTABLE**

## 90602 inclus adaptateur NPT

**DISTRIBUTEUR À 2 VOIES - MANIFOLD**

| D                | L  | E    | CH2 |
|------------------|----|------|-----|
| <b>20-08 1/2</b> | 33 | 34.5 | 30  |
| <b>25-08 1/2</b> | 39 | 42.5 | 35  |



**AJUSTABLE / ADJUSTABLE**

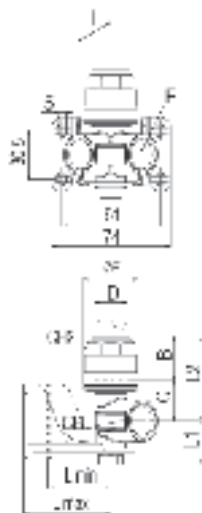

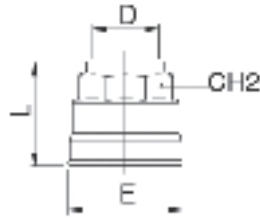

## 90610

BOUCHON - PLUG

| D         | L    | E    | CH2 |
|-----------|------|------|-----|
| <b>20</b> | 33   | 34.5 | 30  |
| <b>25</b> | 39   | 42.5 | 35  |
| <b>32</b> | 46.5 | 52   | 45  |
| <b>40</b> | 53   | 63   | 55  |
| <b>50</b> | 62   | 73   | 65  |
| <b>63</b> | 74.5 | 92   | 70  |

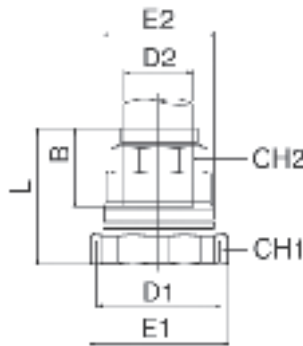

## 90620

RÉDUCTEUR - REDUCER

| D1        | D2        | B    | E1   | E2   | L    | CH1 | CH2 |
|-----------|-----------|------|------|------|------|-----|-----|
| <b>25</b> | <b>20</b> | 31.5 | 43.5 | 34.5 | 48   | 42  | 30  |
| <b>32</b> | <b>20</b> | 31.5 | 54   | 34.5 | 48.5 | 52  | 30  |
| <b>32</b> | <b>25</b> | 38.5 | 54   | 42.5 | 55   | 63  | 35  |
| <b>40</b> | <b>20</b> | 31.5 | 65   | 34.5 | 50   | 63  | 30  |
| <b>40</b> | <b>25</b> | 38.5 | 65   | 42.5 | 56.5 | 63  | 35  |
| <b>40</b> | <b>32</b> | 46   | 65   | 52   | 63.5 | 63  | 45  |



**RETIRER L'ÉCROU  
REMOVE THE NUT**



**INSTALLER Art. 90620  
MOUNT Art. 90620**

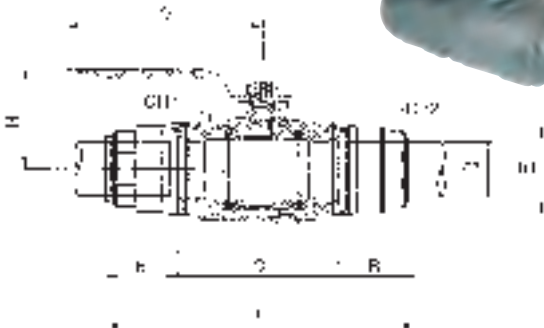
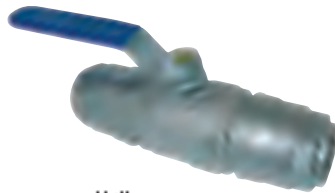

## 90700

ROBINET QUART DE TOUR / TUBE - TUBE BALL VALVE

| D         | DN | B    | C    | E    | L     | CH1 | CH2 | G   | H     |
|-----------|----|------|------|------|-------|-----|-----|-----|-------|
| <b>20</b> | 17 | 31.5 | 58.5 | 34.5 | 121.5 | 32  | 30  | 88  | 42    |
| <b>25</b> | 22 | 38.5 | 61.5 | 42.5 | 138.5 | 41  | 35  | 106 | 47.5  |
| <b>32</b> | 29 | 46   | 75   | 52   | 167   | 50  | 45  | 106 | 53    |
| <b>40</b> | 37 | 52.5 | 81   | 63   | 186   | 59  | 55  | 134 | 65    |
| <b>50</b> | 46 | 63.5 | 103  | 73   | 230   | 69  | 65  | 134 | 72.5  |
| <b>63</b> | 59 | 77   | 126  | 92   | 280   | 92  | 70  | 240 | 111.5 |

**ROBINET QUART DE TOUR PASSAGE LIBRE  
TOTAL FLOW RATE BALL VALVE**



## 90812-20

ATTACHE EN PLASTIQUE STARQUICK 20 mm

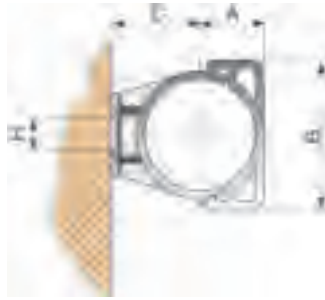
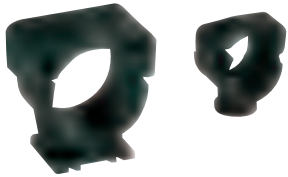

## 90810

ATTACHES DE FIXATION DE TECHNOLIMÈRE  
COLLARS MADE IN TECHNO-POLYMERIC

| D  | H  | A  | B  | C  |
|----|----|----|----|----|
| 25 | M6 | 16 | 39 | 22 |
| 32 | M6 | 20 | 45 | 28 |
| 40 | M6 | 24 | 55 | 32 |
| 50 | M6 | 30 | 68 | 36 |
| 63 | M6 | 37 | 82 | 40 |

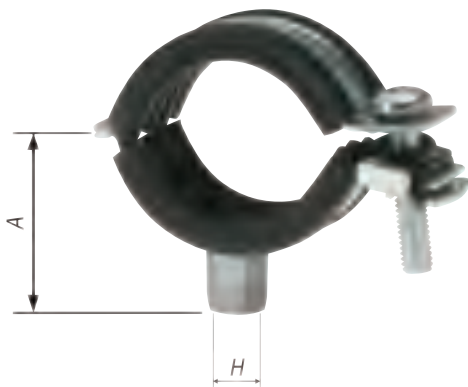

## 90820

ATTACHES DE FIXATION D'ACIER - COLLARS MADE IN STEEL

| D   | H   | A    |
|-----|-----|------|
| 20  | 3/8 | 28.5 |
| 25  | 3/8 | 31   |
| 32  | 3/8 | 34.5 |
| 40  | 3/8 | 39.5 |
| 50  | 3/8 | 44   |
| 63  | 3/8 | 51   |
| 110 | 3/8 | 81.5 |





**90802**  
CADDY CLIP



**13.1760**  
COLLIER POUTRE - YOKE

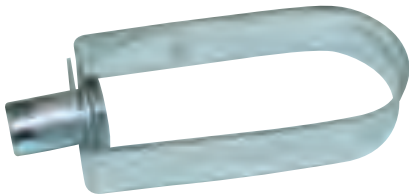

**13.1750**  
BOUCLE CROCHET - HOOK WITH LOOP SHAPE

|                    |        |
|--------------------|--------|
| <b>13.1750.34</b>  | 3/4"   |
| <b>13.1750</b>     | 1"     |
| <b>13.1750.125</b> | 1 1/4" |
| <b>13.1750.150</b> | 1 1/2" |
| <b>13.1750.2</b>   | 2"     |
| <b>13.1750.34</b>  | 2 1/2" |



**13.1755**  
TIGE FILETÉE - THREADED ROD

|                |      |     |
|----------------|------|-----|
| <b>13.1755</b> | 3/8" | 10' |
|----------------|------|-----|



**RACCORD 3 PIÈCES - UNION FITTING 3 PCES**

|                |      |
|----------------|------|
| <b>33.2048</b> | 1/2" |
| <b>33.2068</b> | 3/4" |
| <b>33.2088</b> | 1"   |



**BOYAU ANTI-VIBRATION FLEXIBLE ACIER -  
ANTI-VIBRATION STEEL HOSE**

|                |     |        |
|----------------|-----|--------|
| <b>90.0010</b> | 12" | 3/4"   |
| <b>90.0012</b> | 24" | 3/4"   |
| <b>90.0014</b> | 12" | 1"     |
| <b>90.0016</b> | 24" | 1"     |
| <b>90.0018</b> | 12" | 1 1/4" |
| <b>90.0020</b> | 24" | 1 1/4" |
| <b>90.0022</b> | 12" | 1 1/2" |
| <b>90.0024</b> | 24" | 1 1/2" |
| <b>90.0030</b> | 12" | 2"     |
| <b>90.0032</b> | 24" | 2"     |

FILTRATION D'AIR COMPRIMÉ  
**SERIES 58**  
CONNECTION NF1



| SPÉCIFICATIONS DES FILTRES |              |         |            |
|----------------------------|--------------|---------|------------|
| QCM                        | Point de vue | HAUTEUR | CONNECTION |
| 35                         | 3/2"         | 4.31"   | 3.35"      |
| 50                         | 1"           | 4.31"   | 3.50"      |
| 100                        | 1.412"       | 5.40"   | 6.05"      |
| 175                        | 1.712"       | 5.40"   | 5.85"      |
| 250                        | 1.912"       | 6.70"   | 6.70"      |
| 300                        | 2"           | 6.70"   | 6.00"      |
| 500                        | 2"           | 7.35"   | 7.35"      |



| EQUIPEMENT STANDARD |   | ACCESSOIRES |          |
|---------------------|---|-------------|----------|
| ITEM                | DESCRIPTION                               | QCM         | UNITÉ    |
| 1                   | Manomètre différentiel de pression        | 58-1000     | 50.60 \$ |
| 2                   | Indicateur de niveau de liquide           | 58-1000     | 50.60 \$ |
| 3                   | Clapet (Manostat) (Rouge)                 | 58-1000     | 50.60 \$ |
| 4                   | Pression maximale d'utilisation: 300 psig | 58-1000     | 50.60 \$ |
| 5                   | Temps Maximum d'utilisation: 1500h        | 58-1000     | 50.60 \$ |

| GRADE D'ELEMENT |             |         |          |
|-----------------|-------------|---------|----------|
| ITEM            | DESCRIPTION | QCM     | UNITÉ    |
| 1               | Grade 1     | 58-1000 | 50.60 \$ |
| 2               | Grade 2     | 58-1000 | 50.60 \$ |
| 3               | Grade 3     | 58-1000 | 50.60 \$ |
| 4               | Grade 4     | 58-1000 | 50.60 \$ |
| 5               | Grade 5     | 58-1000 | 50.60 \$ |
| 6               | Grade 6     | 58-1000 | 50.60 \$ |
| 7               | Grade 7     | 58-1000 | 50.60 \$ |
| 8               | Grade 8     | 58-1000 | 50.60 \$ |
| 9               | Grade 9     | 58-1000 | 50.60 \$ |
| 10              | Grade 10    | 58-1000 | 50.60 \$ |



| PRISE - FILTRES & ELEMENTS |         |                        |         |         |         |         |                         |
|----------------------------|---------|------------------------|---------|---------|---------|---------|-------------------------|
| QCM                        | FILTRES | Prix de base - Filtrés | 58      | 07      | 03      | 01      | Prix de base - Elements |
| 35                         | 58-0016 | 162.17 \$              | 58-0016 | 58-0716 | 58-0316 | 58-0116 | 58-0216                 |
| 50                         | 58-0100 | 175.08 \$              | 58-0100 | 58-0710 | 58-0310 | 58-0110 | 58-0210                 |
| 100                        | 58-0104 | 208.02 \$              | 58-0104 | 58-0714 | 58-0314 | 58-0114 | 58-0214                 |
| 175                        | 58-0108 | 240.96 \$              | 58-0108 | 58-0718 | 58-0318 | 58-0118 | 58-0218                 |
| 250                        | 58-0150 | 273.90 \$              | 58-0150 | 58-0750 | 58-0350 | 58-0150 | 58-0250                 |
| 300                        | 58-0156 | 306.84 \$              | 58-0156 | 58-0756 | 58-0356 | 58-0156 | 58-0256                 |
| 500                        | 58-0160 | 410.75 \$              | 58-0160 | 58-0760 | 58-0360 | 58-0160 | 58-0260                 |

# AIRMAX INDUSTRIES INC.



## COMPRESSED AIR FILTRATION SERIES 58 NPT CONNECTION

| HOUSING SPECIFICATIONS |          |         |              |
|------------------------|----------|---------|--------------|
| ITEM                   | NPT PORT | Length  | WEIGHT (lb.) |
| 35                     | 1/2"     | 13-3/4" | 3.72         |
| 60                     | 1"       | 8-1/8"  | 3.80         |
| 100                    | 1-1/2"   | 14-3/8" | 6.62         |
| 175                    | 2"       | 18-1/2" | 6.66         |
| 255                    | 2-1/2"   | 21-1/4" | 8.72         |
| 360                    | 3"       | 29-5/8" | 8.60         |
| 500                    | 4"       | 39-5/8" | 21.55        |

Weights refer to empty housing only.

### STANDARD FEATURES

- Chemical resistant design
- Liquid level indicator
- Manual drain (not pass)
- Maximum working pressure: 200 psig
- Maximum test pressure: 150 P.S.F.

### ACCESSORIES

| ITEM                        | PART NUMBER | LIST PRICE |
|-----------------------------|-------------|------------|
| Excess Flow Drain           | 58-5020     | 30.00 \$   |
| Excess Flow Drain (200psi)  | 11-24376    | 249.00 \$  |
| Liquid Level Indicator      | 58-1032     | 8.00 \$    |
| Differential Pressure Gauge | 58-1028     | 83.00 \$   |

### FILTER GRADE

| Filter Type (ISO 8573-1) | 01       |       | 02       |       | 03       |       | 04       |       | 05       |       | 06       |       | 07       |       | 08       |       | 09       |       | 10       |       |
|--------------------------|----------|-------|----------|-------|----------|-------|----------|-------|----------|-------|----------|-------|----------|-------|----------|-------|----------|-------|----------|-------|
|                          | Standard | Max.  | Standard | Max.  | Standard | Max.  | Standard | Max.  | Standard | Max.  | Standard | Max.  | Standard | Max.  | Standard | Max.  | Standard | Max.  | Standard | Max.  |
| Solids (non-oil)         | 1        | 0.01  | 1        | 0.01  | 1        | 0.01  | 1        | 0.01  | 1        | 0.01  | 1        | 0.01  | 1        | 0.01  | 1        | 0.01  | 1        | 0.01  | 1        | 0.01  |
| Oil (ppm)                | 1        | 0.001 | 1        | 0.001 | 1        | 0.001 | 1        | 0.001 | 1        | 0.001 | 1        | 0.001 | 1        | 0.001 | 1        | 0.001 | 1        | 0.001 | 1        | 0.001 |
| Water (ppm)              | 1        | 0.001 | 1        | 0.001 | 1        | 0.001 | 1        | 0.001 | 1        | 0.001 | 1        | 0.001 | 1        | 0.001 | 1        | 0.001 | 1        | 0.001 | 1        | 0.001 |
| Pressure Drop (psi)      | 1        | 0.05  | 1        | 0.05  | 1        | 0.05  | 1        | 0.05  | 1        | 0.05  | 1        | 0.05  | 1        | 0.05  | 1        | 0.05  | 1        | 0.05  | 1        | 0.05  |
| Pressure Drop (bar)      | 1        | 0.003 | 1        | 0.003 | 1        | 0.003 | 1        | 0.003 | 1        | 0.003 | 1        | 0.003 | 1        | 0.003 | 1        | 0.003 | 1        | 0.003 | 1        | 0.003 |



### PRICES - HOUSINGS & ELEMENTS

| ITEM | HOUSING | LIST PRICE | 01      | 02      | 03      | 04      | 05      | 06      | 07      | 08      | 09      | 10      |
|------|---------|------------|---------|---------|---------|---------|---------|---------|---------|---------|---------|---------|
| 35   | 58-0710 | 162.51 \$  | 58-0716 | 58-0716 | 58-0716 | 58-0716 | 58-0716 | 58-0716 | 58-0716 | 58-0716 | 58-0716 | 58-0716 |
| 60   | 58-0720 | 175.00 \$  | 58-0720 | 58-0720 | 58-0720 | 58-0720 | 58-0720 | 58-0720 | 58-0720 | 58-0720 | 58-0720 | 58-0720 |
| 100  | 58-0724 | 240.00 \$  | 58-0724 | 58-0724 | 58-0724 | 58-0724 | 58-0724 | 58-0724 | 58-0724 | 58-0724 | 58-0724 | 58-0724 |
| 175  | 58-0728 | 345.00 \$  | 58-0728 | 58-0728 | 58-0728 | 58-0728 | 58-0728 | 58-0728 | 58-0728 | 58-0728 | 58-0728 | 58-0728 |
| 255  | 58-0732 | 390.00 \$  | 58-0732 | 58-0732 | 58-0732 | 58-0732 | 58-0732 | 58-0732 | 58-0732 | 58-0732 | 58-0732 | 58-0732 |
| 360  | 58-0736 | 405.00 \$  | 58-0736 | 58-0736 | 58-0736 | 58-0736 | 58-0736 | 58-0736 | 58-0736 | 58-0736 | 58-0736 | 58-0736 |
| 500  | 58-0740 | 415.00 \$  | 58-0740 | 58-0740 | 58-0740 | 58-0740 | 58-0740 | 58-0740 | 58-0740 | 58-0740 | 58-0740 | 58-0740 |

# Sécheur réfrigéré standard Airmax



Afin de bien protéger vos équipements de l'humidité présente dans votre réseau d'air comprimé, Airmax propose l'installation du sécheur réfrigéré de la série 12 du catalogue.

Celui-ci vous donne un point de rosée de 3°C (38°F) à 100 psi. Placé dans un environnement à une température de 3°C (38°F) et plus, celui-ci vous assurera un air sec pour vos équipements et par le fait même prolongera leur vie. Pour un rendement optimal, Airmax vous conseille l'installation de la filtration série #58 à l'entrée et à la sortie du sécheur.

*In order to best protect your equipment from humidity in your air line system, Airmax suggests the installation a refrigerated dryer from our series #12 in catalogue.*

*This provides you a dew point of 3°C (38°F) at 100 psi. Placed in an environment at a temperature of 3°C (38°F) or above will assure dry air for your equipment therefore prolonging its life. For optimal performance Airmax proposes the filtration series #58 at both extremities exit and entrance of the dryer.*

## Spécifications du produit

| Model          | Capacity |                       | Inlet/Outlet<br>npt. male | Power<br>Supply | Input<br>Power<br>(kW) | Refrigerant | Height |     | Width  |     | Depth  |     | Shipping Weight |    |
|----------------|----------|-----------------------|---------------------------|-----------------|------------------------|-------------|--------|-----|--------|-----|--------|-----|-----------------|----|
|                | scfm     | nm <sup>3</sup> /min. |                           |                 |                        |             | inches | mm  | inches | mm  | inches | mm  | lbs             | kg |
| <b>12.7020</b> | 25       | 71                    | 3/4                       | 115/1/60        | 0.41                   | R134a       | 22     | 569 | 15     | 368 | 15     | 368 | 88              | 40 |
| <b>12.7030</b> | 35       | 99                    | 3/4                       | 115/1/60        | 0.46                   | R134a       | 22     | 569 | 15     | 368 | 15     | 368 | 92              | 42 |
| <b>12.7050</b> | 50       | 142                   | 3/4                       | 115/1/60        | 0.57                   | R134a       | 22     | 569 | 20     | 500 | 20     | 500 | 101             | 46 |
| <b>12.7075</b> | 75       | 212                   | 3/4                       | 115/1/60        | 0.72                   | R134a       | 20     | 510 | 19     | 480 | 21     | 526 | 110             | 50 |
| <b>12.7100</b> | 100      | 283                   | 1                         | 115/1/60        | 0.74                   | R134a       | 21     | 525 | 13     | 330 | 30     | 761 | 123             | 56 |
| <b>12.7125</b> | 125      | 354                   | 1                         | 115/1/60        | 0.76                   | R134a       | 21     | 525 | 13     | 330 | 30     | 761 | 133             | 60 |
| <b>12.7150</b> | 150      | 425                   | 1                         | 115/1/60        | 1.11                   | R134a       | 21     | 525 | 13     | 330 | 30     | 761 | 153             | 69 |
| <b>12.7200</b> | 200      | 566                   | 1 1/2                     | 460/3/60        | 1.42                   | R134a       | 30     | 762 | 17     | 437 | 36     | 904 | 183             | 83 |





## 90870

COUPE BOYAU - PIPE CUTTER

20-63



## 90880

ÉBAVURREUR - BURRER

20-40



## VAL01

VALISE DÉMO - DEMO CASE



## PAN01

PANNEAU DÉMO - DEMO PANEL



Le 3 novembre 2010.

MR. CAMERON MOORE  
PRESSURE VESSEL ENGINEERING LTD  
120 RANDAL DR., SUITE B  
WATERLOO ONTARIO  
CANADA N2V 1G8

REFERENCE : C.R.N. application  
PNEUMATIC FITTINGS (CATALOG) JOB#PVE-4021  
(SEE SCOPE OF REGISTRATION)

TEES; ELBOWS & STRAIGHT PNEUMATIC FITTINGS FROM 20MM TO  
100MM DIAMETER

OUR REFERENCE : 964897

MANUFACTURER AIGNEP S.P.A  
VIA DON BAZZOLI 34-I-25070  
BIONE  
ITALY

Dear Sir,

According to our law respecting pressure vessels, your plans have been accepted and registered under the number OA13982.56.

GILLES BONNIER

Inspecteur

Service de l'inspection de la fabrication  
d'appareils sous pression  
515, boulevard Crémazie est, 7<sup>ème</sup> étage  
Montréal (Québec) Canada  
H2M 2V2

Téléphone : (514) 873-6159  
Sans frais : 1 866 282-2084  
Télécopieur : (514) 873-9936



4th Floor, Centre Tower  
1080 Bloor Street West,  
Toronto, Ontario  
M6H 1B5  
Tel: 416-734-3457  
Fax: 416-231-8183  
Toll Free: 1-877-462-8772

[www.tssa.org](http://www.tssa.org)

July 29, 2010

CAMERON MOORE  
PRESSURE VESSEL ENGINEERING LTD.  
120 RANDALL DR. Suite B  
WATERLOO ON N2V 1G6  
CA

**Service Request Type:** BPV-Fitting Registration  
**Service Request No.:** 420724  
**Your Reference No.:** PVE-4021

Dear CAMERON MOORE,

Technical Standards and Safety Authority (TSSA) is pleased to inform you that your submission on July 08, 2010 has been reviewed and registered as follows:

**CRN No.:** 0A13982.5  
**Reference No.:** PVE-4021  
**Main Design No.:** S004000001 ETAL (SEE AIGNEP PNEUMATIC TUBE COUPLINGS SCOPE OF REGISTRATION)  
**Expiry Date:** July 29, 2020

Please be advised that a valid quality control system must be maintained for the fitting registration to remain valid until the expiry date.

**For complete scope, see 3 pages of attachment to Statutory Declaration.**

A stamped copy of the approved registration and invoice for engineering services will be mailed to you shortly. Should you have any questions or require further assistance, however, please contact a Customer Service Advisor at 1,877.632.TSSA (8772) or e-mail [customerservices@tssa.org](mailto:customerservices@tssa.org). We will be happy to assist you. When contacting TSSA regarding this file, please refer to the Service Request number provided above.

Yours truly,

Kaiwan Kia P. Eng.  
Mechanical Engineer, BPV  
Tel : 416-734-3457  
Fax : 416-231-8183  
Email : [kkia@tssa.org](mailto:kkia@tssa.org)

**Putting Public Safety First** © 2010 TSSA. All rights reserved. TSSA is a registered trademark of the Technical Standards and Safety Authority.



**950, ANDRÉ-LINÉ  
GRANBY (QUÉBEC) J2J 1E2**

**TEL. : 1 888 730-0501  
450 375-0501**

**FAX : 1 888 730-3522  
450 375-3644**

**[WWW.AIRMAX.CA](http://WWW.AIRMAX.CA)**